



# froli®

## Travel Sleep System

### Assembly Instructions

#### IMPORTANT!

READ THESE INSTRUCTIONS BEFORE ASSEMBLY.

To ensure that the bed base has the strength and stability necessary to withstand heavy loads, the elements must be securely fixed together. The clips are intentionally fixed in position to prevent accidental opening under load.

Congratulations on purchasing your Froli® Travel kit.

Please follow the instructions below to ensure correct assembly and use. If you have any questions, please do not hesitate to contact the Australian distributor, A Better Way To Go, on (03) 9421 4235. We know you will enjoy this product and wish you a healthy, relaxing sleep.

#### Assembly

Froli® Travel can be clipped together with narrow, medium or wide spacing by varying the distance between the holes. This enables the degree of hardness to be varied to suit your body weight. For a body weight in excess of 90kg we recommend that you should always use the narrow clip spacing.

#### Step 1.

1. Layout the individual Base Elements in a uniform pattern over the sleeping area. Keep the arrow mark on the elements pointing to the head of the bed. The elements can easily be rotated to fit corners and bevells or you can use using ½ Elements. (If not included with your kit, but required, you will need to order an Expansion Spring Kit.)
2. Connect the Base Elements. Choose narrow, medium or wide hole spacing. Push down the button and then push them together at the same time. (Fig 1)

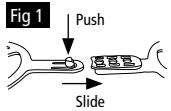

#### Step 2.

1. After assembling all of the Base Elements, start to add two rows of Regular springs (dark blue) where your pillow will be.
2. Turn the Spring Element 90 degrees until the slot engages and the spring is square on to the mat. (Fig 2)
3. The Soft Spring Elements (light blue) should be preferably placed in rows 3 and 4 to align with your shoulders.
4. Any overhanging base element parts can be trimmed to fit inside the available space by using edge cutters.

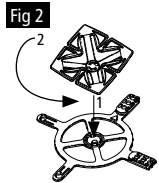

#### Step 3.

The tension units provided in the kit create firmer lumbar support (to prevent hollow back) and can be clipped on as required into the middle of the regular spring units in the holes provided, making sure they lock in-position. (Fig 3)

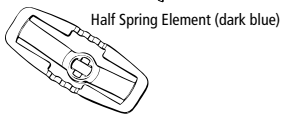
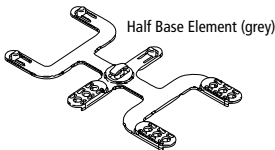
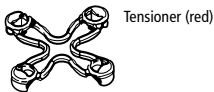
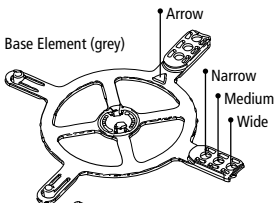
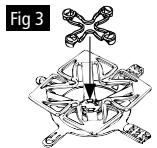

#### Instructions for care, use and recycling

Froli® Travel is a high quality product made from thermoplastic polyester elastomer. This type of plastic is exceptionally resilient and possesses enormous ductility and elasticity. To ensure that your Froli® Travel sleep system gives you many years of service, avoid exposing it to direct UV radiation for prolonged periods of time and do not leave the clip system rolled up for long periods of time. If necessary wipe the plastic elements with a mild care product. Do not use strong detergents, abrasive cleaners, alcohol, cellulose thinners, acetone or other aggressive agents. This product was manufactured so that it can be dismantled in compliance with environmental legislation. After dismantling, Froli® Travel components can be recycled.



Distributed in Australia by

A Better Way To Go

P.O.Box 203 Richmond Victoria 3121 T 03 9421 4235

[www.abetterwaytogo.com.au](http://www.abetterwaytogo.com.au)